

alle Ecken und Kanten abgerundet
 Radius ca. 0,75mm

Elektrode von Hand poliert (frei von Kratzern und Riefen)

Reinigung nach Technischer Richtlinie 6.2

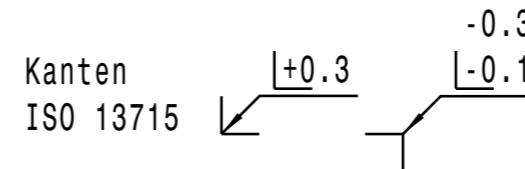
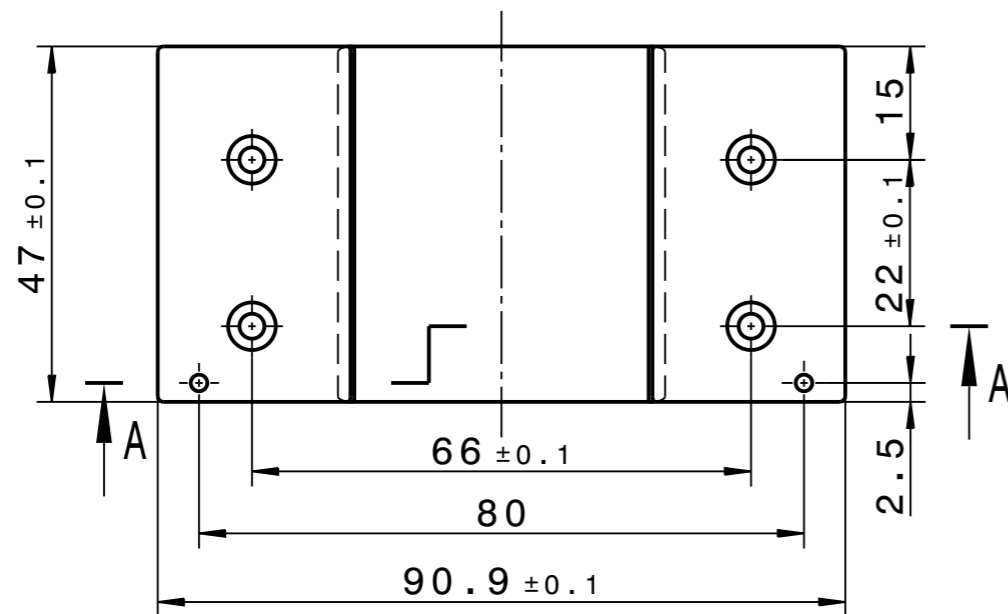

Copying of this document and giving it to others and the use of communication of the contents thereof are forbidden without express authority. Offenders are liable to the payment of damages. All rights are reserved in the event of the grant of a patent or the registration of a utility model or design.		Projection 	Rev. No.	Rev.-Doc.-No.	Date	Name
		Surfaces DIN ISO 1302	For information			
GSIT Helmholtzzentrum für Schwerionenforschung GmbH Planckstrasse 1, 64291 Darmstadt		Dimensions without tolerance indication DIN ISO 2768-mK EN ISO 13920-BF	Weight Material 1.4301 (X5CrNi18-10)	Scale 1:1		
		Description Elektrode hinten unten		Size A3		
Drawn 29.07.2013 Hartung, M.	Drawing No. STD-000-L01.073.000		Rev. -	Sheet 1 of 1		
Checked 	Drawing No.		Rev.	Sheet 1 of 1		
Approved 	Drawing No.		Rev.	Sheet 1 of 1		
IP	Prev. Dwg.		Repl. for			